

Fixed Attenuator

- ◆ DC to 6 GHz
- ◆ 15dB
- ◆ 5 Watt
- ◆ N Type Connectors

Features

- High attenuation accuracy
- Small VSWR
- Ceramic chip
- Low cost-high performance

Model No. Description

FATXXXXXX

- X- power handling: 2W or 5W.
- X- connector type: SMA, N type or SMB connector.
- XX- attenuation: **dB.
- XX- 06 represents type number

Specifications

Frequency Range DC to 6 GHz
 Attenuation 15 dB
 Attenuation Accuracy (Max.) ±0.7 dB over DC - 6 GHz

Nominal Impedance 50 Ohm
 Average Power 5 Watt
 Operating Temperature -55 °C to +125°C
 Storage Temperature -55 °C to +125°C

FREQ. RANGE (GHz)	Typical VSWR(:1)	Maximum VSWR(:1)
DC to 3	1.10	
3 to 4	1.15	
4 to 6	1.25	
DC to 6		1.30

Material & Plating

Parts	Material	Plating(Micro-inch)
Body & Nut	Brass	Ternary alloy
Contact (female & male)	QSn6.5-0.1	Gold 30
Insulator	Teflon	

Characteristic

For example the testing curves of FAT0615N5

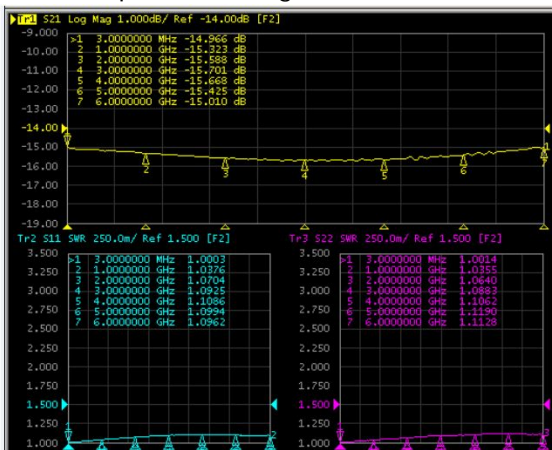

Package Outlines

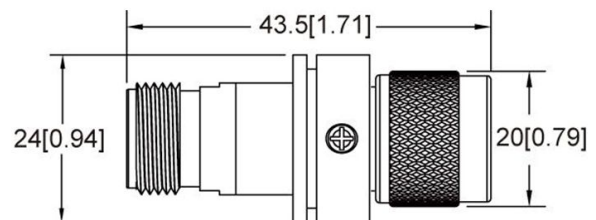

Package type: N

Note: all dimensions shown in mm & inch

Note:**Average power at 25°C ambient, derate linearly to 0.5W at 125°C**