

Features:

- 5000-9200 MHz
- 50 Ohm to 2 x 50 Ohm
- 0.54mm Height Profile
- 5G (n104) & 6G Applications
- Very Low Loss (<0.9dB)
- Tight Amplitude Balance (± 1.0 dB)
- Non-conductive Surface
- Production Friendly
- RoHS Compliant
- Halogen Free
- Tape and Reel

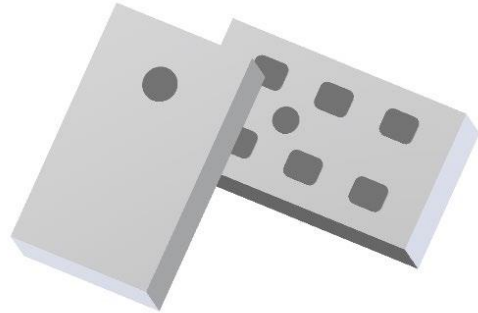

Electrical Specifications

Parameter	Min.	Typ.	Max	Min.	Typ.	Max	Unit
Frequency	5800		8400	5000		9200	MHz
Unbalanced Port Impedance		50			50		Ohm
Balanced Port Impedance		100			100		Ohm
Return Loss	15			13			dB
Insertion Loss			0.8			0.9	dB
Amplitude Balance			± 1.0			± 1.0	dB
Phase Balance	170		190	165		195	Degrees
CMRR	20			15			dB
Power (Avg. Watts @105°C)			1			1	Watts
Operating Temperature	-55		140	-55		140	°C

Outline Drawing:

