

### Features

- Multilayer monolithic construction yields high reliability
- Low insertion loss and small size SMD chip design
- Can simplify your complex tuning and circuit design
- LTCC process

### Specifications

NO.	Parameter	Frequency (MHz)	SPC		
			Min.	Typ.	Max.
1	Insertion Loss (dB) 25°C	4900-5950		1.6	2.0
2	Insertion Loss (dB)-40 to +85°C	4900-5950		1.9	2.3
3	Return Loss(dB)	4900-5950	9	11	-
4	Attenuation (dB)	1280-3300	40	50	-
		3300-4000	25	33	-
		4375-4465	7	12	-
		7300-8930	14	18	-
5	In/Output Impedance ( $\Omega$ )	9800~11900	25	38	-
<b>Operating &amp; Storage Condition (Component)</b> Operation Temperature Range: -40°C ~ +85°C Storage Temperature Range: -40°C~ +85°C					
<b>Storage Condition before Soldering (Included packaging material)</b> Storage Temperature Range: +5 ~ +40 °C Humidity: 30 to 70% relative humidity					

### Construction

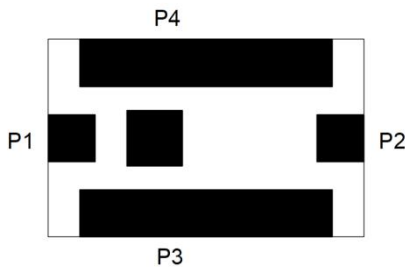

PIN	Connection
P1	Input port
P3	GND
P2	Output port
P4	GND

### Mounting Considerations

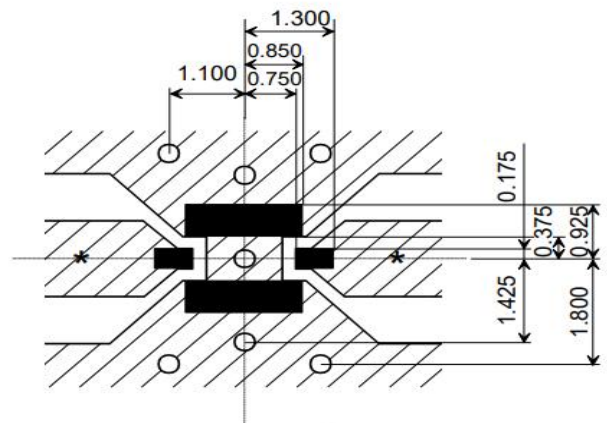

Unit: mm

Line width to be designed to match 50  $\Omega$  characteristic impedance, depending on PCB material and thickness

### Yantel Corporation

Add: No.308-322,3F,Building 1,Juchuang Jingu Innovation Park,Wenyuan Road 35,Xili Street,Nanshan,Shenzhen,China

Tel: 86-755-8355-1886 Fax: 86-755-8355-2533

For detailed performance specs & shopping online see Yantel web site : [www.yantel-corp.com](http://www.yantel-corp.com)

### Dimensions

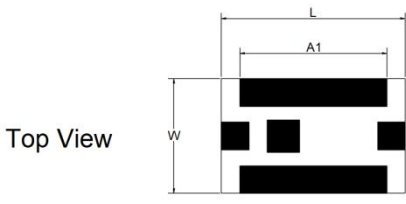
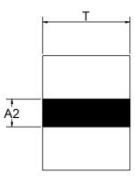
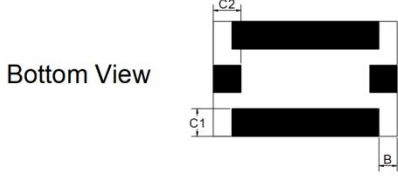
Figure	Symbol	Dimension (mm)
	L	2.0 ± 0.10
	W	1.25 ± 0.10
	T	0.95 ± 0.10
	A2	0.3 ± 0.10
	A1	1.6 ± 0.10
	B	0.25 ± 0.10
	C1	0.2 ± 0.10
	C2	0.2 ± 0.10

### Typical Electrical Characteristics (T=25°C)

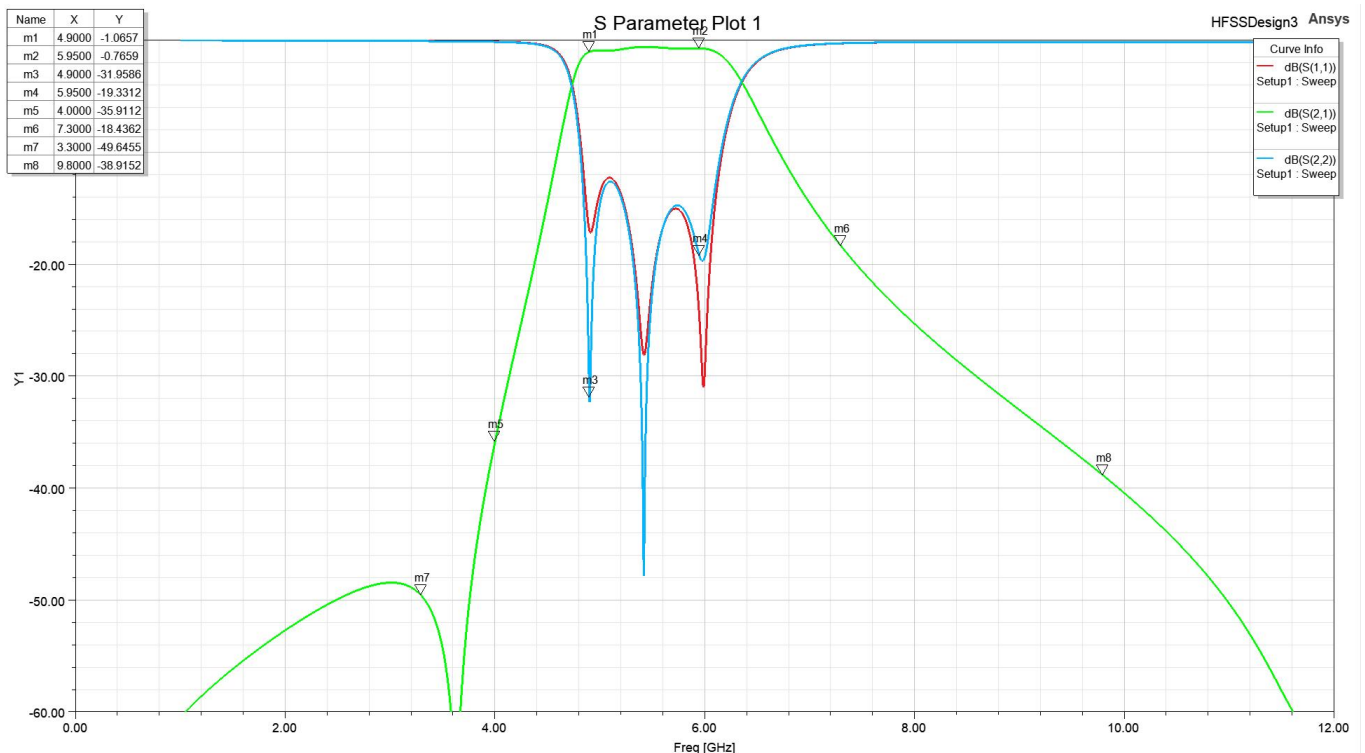

### Yantel Corporation

Add: No.308-322,3F,Building 1,Juchuang Jingu Innovation Park,Wenyuan Road 35,Xili Street,Nanshan,Shenzhen,China

Tel: 86-755-8355-1886 Fax: 86-755-8355-2533

For detailed performance specs & shopping online see Yantel web site : [www.yantel-corp.com](http://www.yantel-corp.com)

### Solder Reflow Standard Conditioning

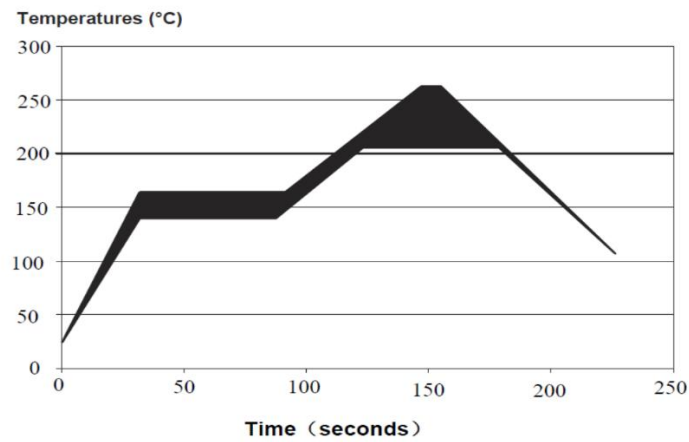

### Storage Conditions

Temperature : +5 to +30 °C

Humidity : 20 to 70% RH

Term of storage : Within 12 months (After the delivery) \*

Baking : Unnecessary

\* After peeling off cover tape, do not keep exposing the products to the open air. For the products stored longer than 12 months, confirm their terminals and solderability before use.